

# Response to Tower Hamlets Proposal 'Liveable Streets Bethnal Green'

*Drawings produced on behalf of local residents and businesses to better address the acknowledged problems experienced in our neighbourhood*

# Shoreditch to Bethnal Green – Liveable Streets

## **Suggested principles for approach to street improvements:**

- Improve air quality on all streets;
- Reduce street noise, particularly at night;
- Reduce through-traffic movements;
- Reduce opportunities for anti-social behaviour (esp. drug-dealing and street drinking);
- Improve quality of streets for pedestrians and cyclists;
- Improved safety of streets for pedestrians and cyclists;
- Improve quality of public realm generally;
- Support local businesses and markets to operate efficiently.

## **Potential negatives:**

- Significant inconvenience for local residents' and businesses' vehicle movements including: business deliveries, market services, taxi drop-off/pick-up, disabled/elderly drop-off/pick-up, and emergency services;
- Increased driving distances for residents/businesses;
- Worsening air quality and noise issues on adjacent major routes.

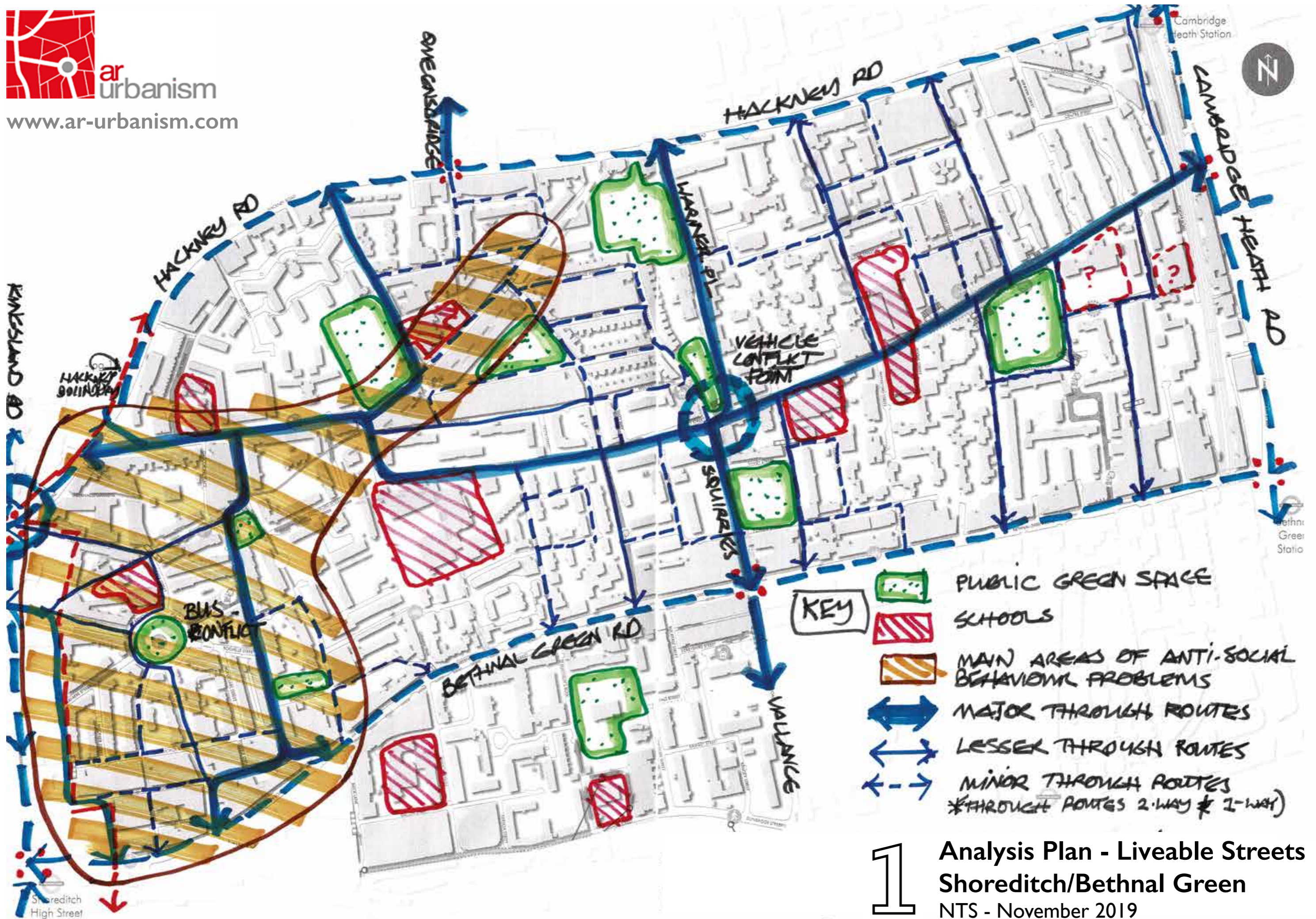

1

Analysis Plan - Liveable Streets  
Shoreditch/Bethnal Green  
NTS - November 2019

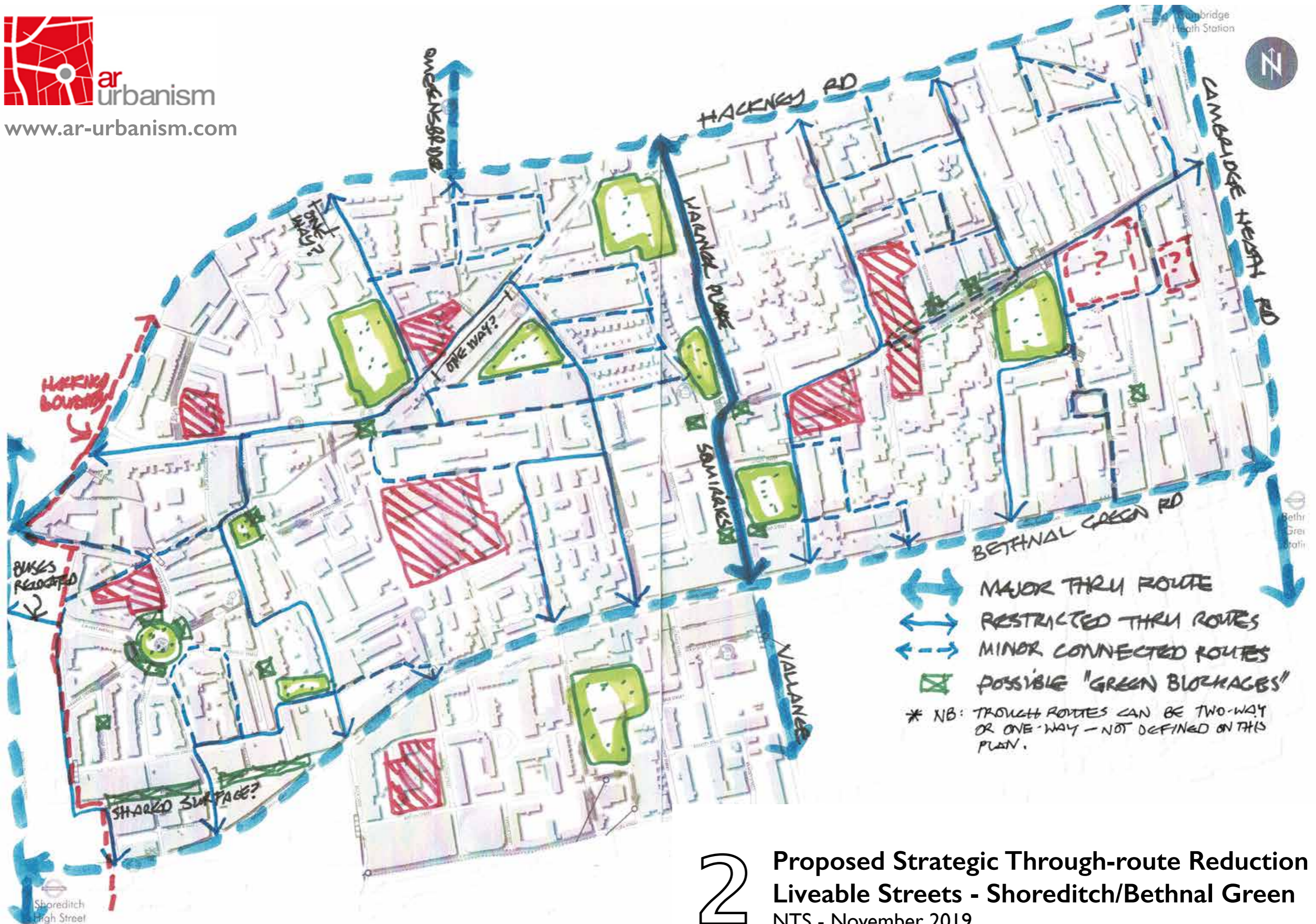

# 2

Proposed Strategic Through-route Reduction  
 Liveable Streets - Shoreditch/Bethnal Green  
 NTS - November 2019



ar urbanism

www.ar-urbanism.com

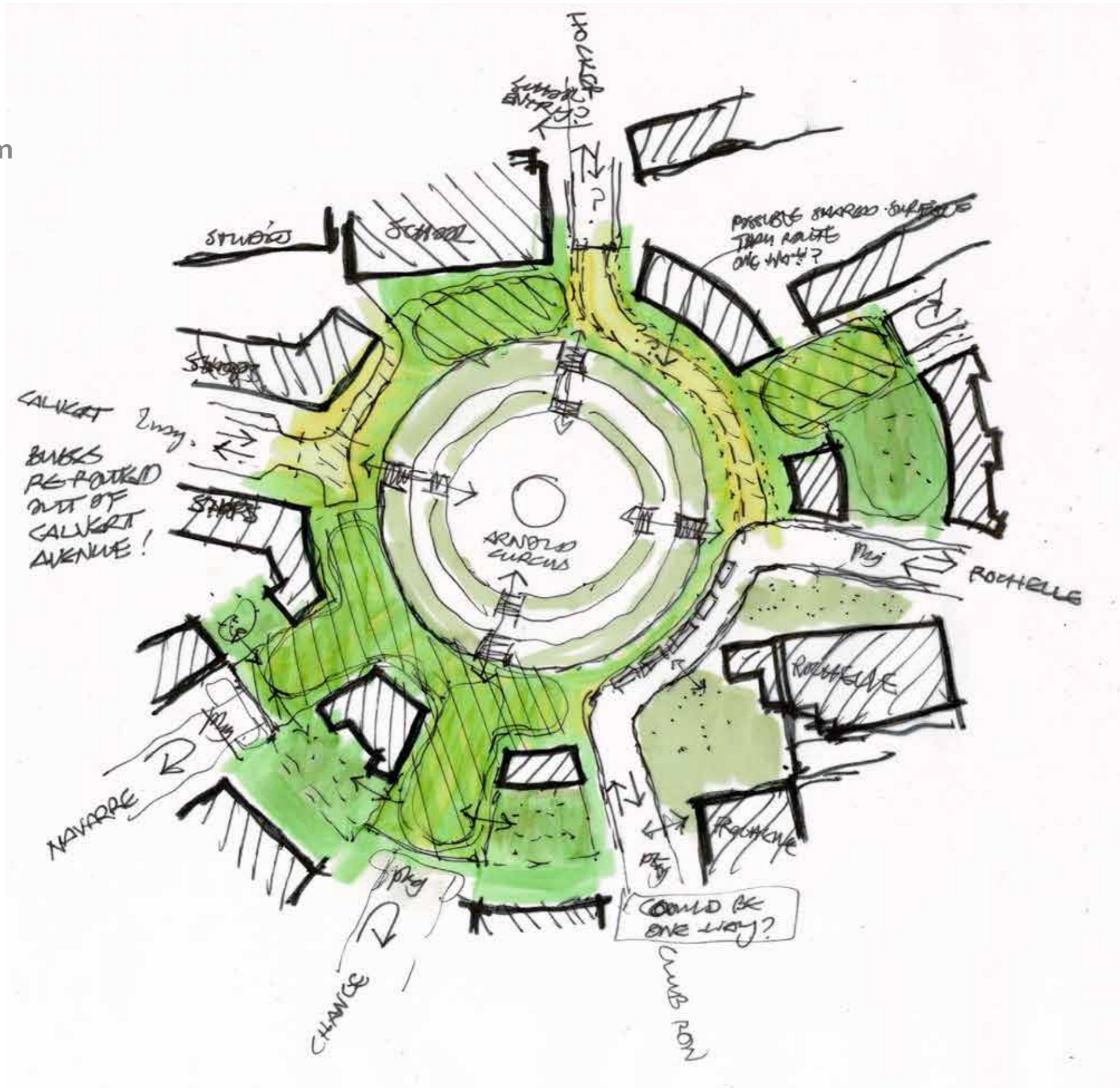

3

Proposed Option for Arnold Circus  
Liveable Streets - Shoreditch/Bethnal Green  
NTS - November 2019